

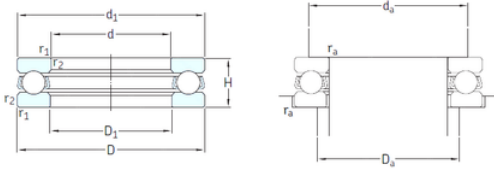

NTNY BEARING LTD

skf 51206 bearing

Bearing No. 51206



51206 Bearing 2D drawings and 3D CAD models

Size	30x52x16 mm
Bore Diameter	30 mm
Outer Diameter	52 mm
Width	16 mm
d	30 mm
D	52 mm
H	16 mm
d1	52 mm
r1 min.	0,6 mm
r2 min.	0,6 mm
D1	32 mm
da min.	43 mm
Da max.	39 mm
ra max.	0,6 mm
Weight	0,13 Kg
Basic dynamic load rating (C)	25,1 kN
Basic static load rating (C0)	51 kN
Fatigue load limit (Pu)	1,86
Reference speed	4800 r/min
Limiting speed	6700 r/min
Category	Thrust Ball Bearing
Inventory	0.0
Manufacturer Name	SKF
Minimum Buy Quantity	N/A
Weight / Kilogram	0.139
EAN	7316577058515



NTNY BEARING LTD

Product Group	B00308
Rolling Element	Ball Bearing
Thrust Bearing	Yes
Single or Double Direction	Single Direction
Banded	No
Cage Material	Steel
Precision Class	ABEC 1 ISO P0
Component Description	Roller Assembly Plus Raceways
Other Features	Single Row
Long Description	30MM Bore 1; 32MM Bore 2; 52MM Outside Diameter; 16MM Height; Ball Bearing; Single Direction; Not Banded; Steel Cage; ABEC 1 ISO P0 Precision
Inch - Metric	Metric
Category	Thrust Ball Bearings
UNSPSC	31171507
Harmonized Tariff Code	8482.10.50.08
Noun	Bearing
Keyword String	Ball Thrust
Manufacturer URL	http://www.skf.com
Manufacturer Item Number	51206
Weight / LBS	0.307
Height	0.63 Inch 16 Millimeter
Outside Diameter	2.047 Inch 52 Millimeter
Bore 2	1.26 Inch 32 Millimeter
Overall Height with Aligning Washer	0 Inch 0 Millimeter
Bore 1	1.181 Inch 30 Millimeter
bore diameter:	30 mm
static load capacity:	51 kN
outside diameter:	52 mm



NTNY BEARING LTD

dynamic load capacity:	25.1 kN
overall width:	16 mm
maximum rpm:	6700 RPM
thrust bearing type:	Single-Direction
cage material:	Steel
outside diameter design:	Straight
fillet radius:	0.6 mm
separable or banded:	Separable
series:	512
precision rating:	ABEC 1 (ISO Class Normal)
d_1	52 mm
D_1	32 mm
$r_{1,2}$ min.	0.6 mm
d_a min.	43 mm
D_a max.	39 mm
r_a max.	0.6 mm
Basic dynamic load rating C	25.1 kN
Basic static load rating C_0	51 kN
Fatigue load limit P_u	1.86 kN
Minimum load factor A	0.013
Mass bearing (including seat washer where applicable)	0.13 kg