

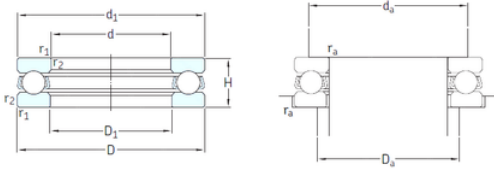

# NTNY BEARING LTD

## skf 51110 bearing

Bearing No. 51110



51110 Bearing 2D drawings and 3D CAD models

Size	50x70x14 mm
Bore Diameter	50 mm
Outer Diameter	70 mm
Width	14 mm
d	50 mm
D	70 mm
H	14 mm
d1	70 mm
r1 min.	0,6 mm
r2 min.	0,6 mm
D1	52 mm
da min.	62 mm
Da max.	58 mm
ra max.	0,6 mm
Weight	0,16 Kg
Basic dynamic load rating (C)	27 kN
Basic static load rating (C0)	75 kN
Fatigue load limit (Pu)	2,8
Reference speed	4300 r/min
Limiting speed	6300 r/min
Category	Thrust Ball Bearing
Inventory	0.0
Manufacturer Name	SKF
Minimum Buy Quantity	N/A
Weight / Kilogram	0.167
EAN	7316576677380



## NTNY BEARING LTD

Product Group	B00308
Rolling Element	Ball Bearing
Thrust Bearing	Yes
Single or Double Direction	Single Direction
Banded	No
Cage Material	Steel
Precision Class	ABEC 1   ISO P0
Component Description	Roller Assembly Plus Raceways
Other Features	Single Row
Long Description	50MM Bore 1; 52MM Bore 2; 70MM Outside Diameter; 14MM Height; Ball Bearing; Single Direction; Not Banded; Steel Cage; ABEC 1   ISO P0 Precision
Inch - Metric	Metric
Category	Thrust Ball Bearings
UNSPSC	31171507
Harmonized Tariff Code	8482.10.50.08
Noun	Bearing
Keyword String	Ball Thrust
Manufacturer URL	<a href="http://www.skf.com">http://www.skf.com</a>
Manufacturer Item Number	51110
Weight / LBS	0.368
Bore 1	1.969 Inch   50 Millimeter
Outside Diameter	2.756 Inch   70 Millimeter
Height	0.551 Inch   14 Millimeter
Bore 2	2.047 Inch   52 Millimeter
Overall Height with Aligning Washer	0 Inch   0 Millimeter
bore diameter:	50 mm
static load capacity:	75 kN
outside diameter:	70 mm



## NTNY BEARING LTD

dynamic load capacity:	27 kN
overall width:	14 mm
maximum rpm:	6300 RPM
thrust bearing type:	Single-Direction
cage material:	Steel
outside diameter design:	Straight
fillet radius:	0.6 mm
separable or banded:	Separable
series:	511
precision rating:	ABEC 1 (ISO Class Normal)
$d_1$	70 mm
$D_1$	52 mm
$r_{1,2}$ min.	0.6 mm
$d_a$ min.	62 mm
$D_a$ max.	58 mm
$r_a$ max.	0.6 mm
Basic dynamic load rating C	27 kN
Basic static load rating $C_0$	75 kN
Fatigue load limit $P_u$	2.8 kN
Minimum load factor A	0.029
Mass bearing (including seat washer where applicable)	0.16 kg